

# LINEA-4C

## LINEA-4C/W

## LINEA-4C/OR

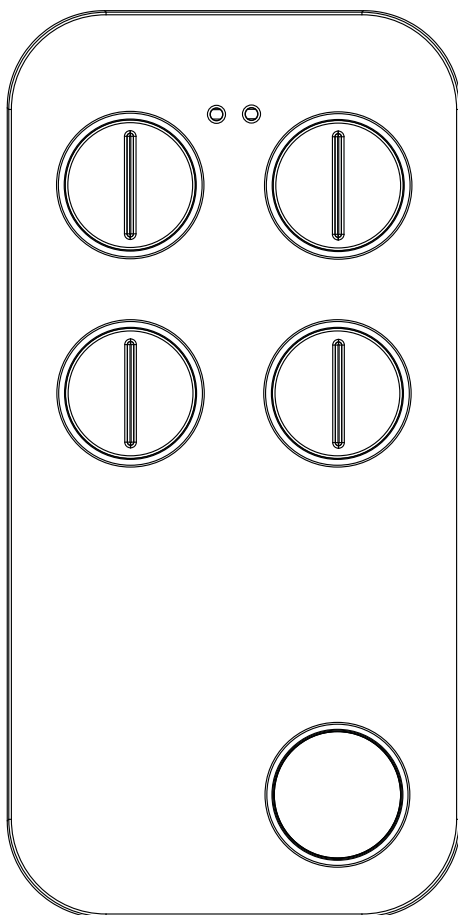

1 - PRODUCT FEATURES

1.1 DESCRIPTION

Multi-frequency (433.92 MHz or 868 MHz) remote control with 4-zone and duplicator function included.  
It's possible to duplicate remotes with single code or rolling code type 1, rrolling code type 2 (brands BFT, V2 and FAAC) or make copies of already "cloned" remote controls, see paragraph No.3

1.2 TECHNICAL DATA

|              |                     |
|--------------|---------------------|
| Power supply | Battery type CR2032 |
| RF frequency | 433.92MHz / 868 MHz |
| Channels     | 4                   |
| Dimensions   | 71x36x8 mm          |

2 - USE OF REMOTE CONTROL

The remote control can be used by programming it directly on compatible Nexta Tech receivers or it can be used to duplicate existing transmitters.

DIRECT PROGRAMMING ON COMPATIBLE RECEIVERS

The remote control can be associated with any Nexta Tech control unit, see the receiver control unit manual.

COPY FUNCTION

The radio control has the function of duplication towards the transmitters present on the market with fixed code or rolling compatible type. See compatibility table in paragraph 4.  
To duplicate a key of an existing transmitter:  
1- carry out the procedure in paragraph 3 based on the original remote control "  
2- insert the cloned key of the "copier remote control" in the receiver memory. The insertion can be done "manually" with access to the receiving unit or, if the transmitter allows it, with a procedure on the "copier radio control", see paragraph 4.

CAUTION:

- Each button of the remote control can have a different function. Therefore it is possible to duplicate up to 4 remote controls using a single copier

### 3 - DUPLICATE REMOTES

#### Notes

- If the RED LED flashes only 3 times and goes off, the code has not been learned correctly, then repeat the operation from point 1.
- Several radio transmitters codes can be duplicated and saved to each button
- Internal memory is rewritable.

#### 3.1 - PROCEDURE TO DUPLICATE REMOTES WITH SINGLE CODE OR ROLLING CODE TYPE 1

##### STEP 1

At the same time press and hold button No.1 and push 4 times button No.2 (Fig.1).

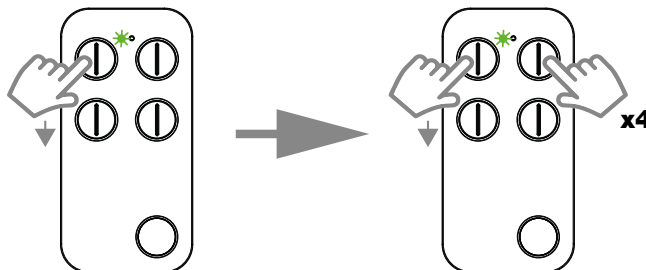

##### STEP 2

Now stop pressing buttons. Then the RED LED starts blinking every 2 seconds.

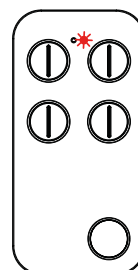

##### STEP 3

Position the "remote control to be duplicated" in front of the "copying radio remote" at a distance of about 1-2 cm, then Press and hold the button of the "remote control to be cloned" and wait for the RED LED of the "copying radio control" to change flashing (faster) and color (GREEN), confirming the correct learning of the code. This can take a few seconds.

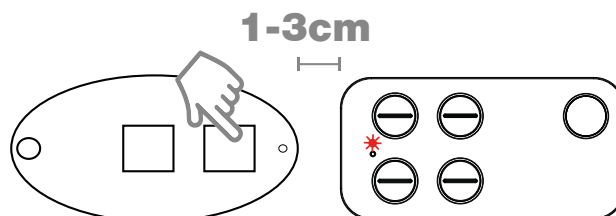

##### STEP 4

While the GREEN LED is flashing, press the button of the "copier radio control" on which you want to enter the duplicated code and keep it pressed until the LED switches off to confirm that the code has been correctly learned. Copying was successful.

If the remote control is a fixed code

##### STEP 5a

The transmitter is already functional

If the remote control is a rolling type 1

##### STEP 5b

Insert the "programmed copier radio control" with the remote learning procedure (depends on the model copied) or with a standard association procedure. See paragraph 4

3.2 - PROCEDURE FOR THE DUPLICATION OF A TYPE 2 ROLLING CODE (BFT, V2, FAAC)

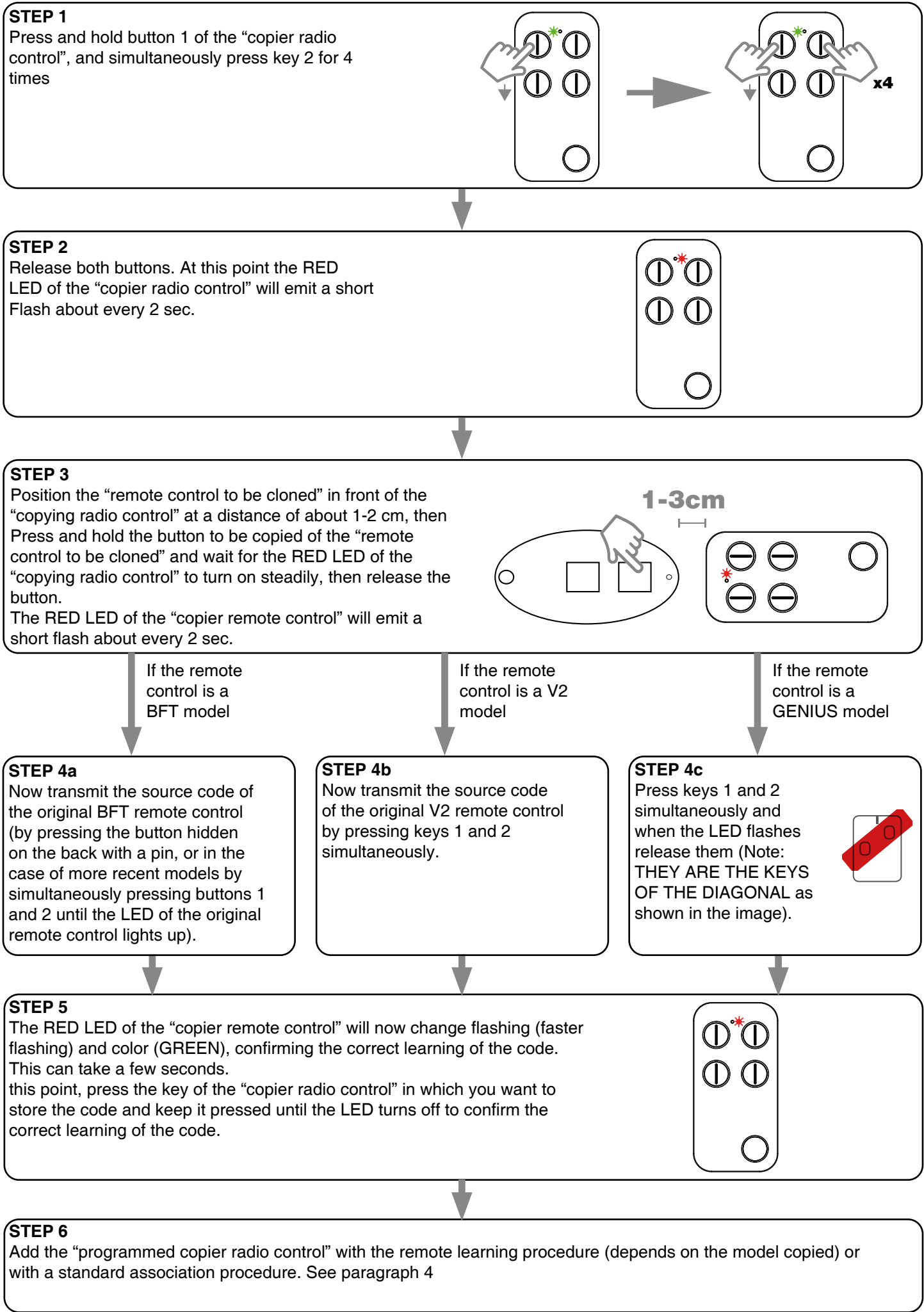

### 3.3 - PROCEDURE FOR THE DUPLICATION OF A “COPIER REMOTE CONTROL” WITH ANOTHER COPIER REMOTE CONTROL

EN

This procedure makes it possible to duplicate an already cloned button of a “copier radio control” on another “new copier radio control”.

#### STEP 1

Press and hold button 1 of the “copier radio control”, and simultaneously press key 2 for 4 times

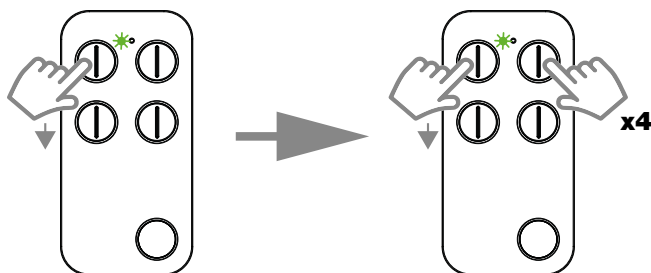

#### STEP 2

Release both buttons. At this point the RED LED of the “copier radio control” will emit a short flash about every 2 sec.

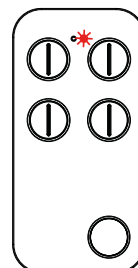

#### STEP 3

Position the “remote control to be cloned” in front of the “copying radio control” at a distance of about 1-2 cm

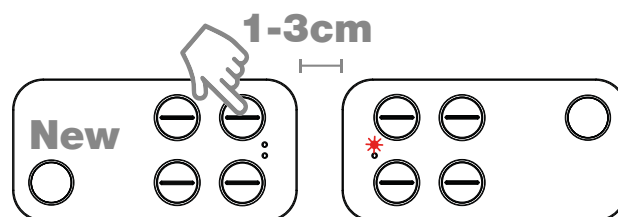

If I am copying a  
fixed code or a  
rolling type 1

If I am copying a  
rolling type 1

#### STEP 4a

Wait for the RED LED of the “new copier transmitter” to change flashing (faster flashing) and color (GREEN), confirming the correct learning of the code. This can take a few seconds.

#### STEP 4b

The RED LED of the “copier transmitter” will emit a short flash about every 2 seconds. Now transmit the SEED CODE of the “remote control to be cloned” by simultaneously pressing keys 1 and 2 for about 3 seconds, until the RED LED lights up. While the LED is flashing (within 10 seconds) press and hold down the key whose source code you want to copy.

#### STEP 5a

While the GREEN LED is flashing, press the key of the “new copier transmitter” on which you want to enter the code just learned and keep it pressed until the LED switches off to confirm the correct learning of the code.

#### STEP 5b

The RED LED of the “copier remote control” will now change flashing (faster flashing) and color (GREEN), confirming the correct learning of the code. This can take a few seconds. At this point, press the key of the “new copier remote control” in which you want to store the code and keep it pressed until the LED turns off to confirm the correct learning of the code.

#### STEP 6

Insert the “programmed copier radio control” with the remote learning procedure (depends on the model copied) or with a standard association procedure. See paragraph 4).

## 4 - LIST OF COMPATIBLE REMOTE CONTROLS AND METHOD OF INSERTION IN THE RECEIVER'S MEMORY

Below is the list of compatible rolling code remote controls and the method for inserting the "copying remote control" in the receiver based on the brand.

### TYPE A PROGRAMMING

Access the receiver, activate listening (see receiver manual) and then press the "copier radio control" button.

### TYPE B PROGRAMMING

Near the automation and before using the original remote control, press and hold down the "copying radio control" button until the LED starts flashing. Wait for the blinking to stop.

### TYPE C PROGRAMMING

Near the automation and before using the original remote control, press the "copier radio control" button 4/5 times.

| BRAND<br>MODEL  | TYPE OF<br>COPY |
|---|-----------------|
| <b>ACM</b>  |                 |
| TX2, TX2 COLOR, TX4   | <b>A</b>        |
| <b>ADYX</b>   |                 |
| TE4433H BLUE, 433-HG BRAVO  | <b>B</b>        |
| <b>AERF</b>   |                 |
| COMPACT, HY-DOM, MERCURI B, MERCURI C, SABUTON, MARS, SATURN, ST3/N, TERRA, TMP-1, TMP-2, UNITECH | <b>B</b>        |
| <b>ALLMATIC</b>   |                 |
| BROWN, BROWN RED, BRO.OVER, PASS, MINIPASS, TECH3, FOR4   | <b>B</b>        |
| <b>APERIO</b>   |                 |
| GO, GO PRO, GO MINI   | <b>A</b>        |
| <b>APERTO (Sommer)</b>  |                 |
| 4020-TX03-434, TX02-434-2, TX02-868-2   | <b>A</b>        |
| <b>APRIMATIC</b>  |                 |
| TR, TM4, TXM  | <b>B</b>        |
| <b>AVIDSEN</b>  |                 |
| 104251, 104250, 104250 OLD, 104250 RED, 104257, 104350, 654250, TX4 114253                        | <b>A</b>        |
| <b>BALLAN</b>   |                 |
| FM400, FM400E   | <b>A</b>        |
| <b>BENINCA</b>  |                 |
| TO. GO. WV, TWV, ROLLKEY, APPLE, LOT WCV, CUPIDO, TO.GO. QV, HAPPY VA                             | <b>B</b>        |
| IO, TO.GO. VA   | <b>A</b>        |
| <b>BFT</b>  |                 |
| MITTO, MITTO M, MITTO RCB, MITTO A, TRC, GHIBLI, MURALE, KLEIO                                    | <b>B</b>        |
| <b>CARDIN</b>   |                 |
| TRQ S449, TRQ S449 GREEN (PRECODE), TXQ S449, TXQ S449 GREEN, TRQ S486, TXQ S486, S437 TX, XRADO  | <b>B</b>        |
| <b>CASALI</b>   |                 |
| GENIUS/CASALI A252RC  | <b>B</b>        |

| BRAND<br>MODEL  | TYPE OF<br>COPY |
|---|-----------------|
| <b>CHAMBERLAIN, LIFT MASTER, MOTOR LIFT</b>   |                 |
| 953ESTD, 371 LM, 971LM, 84330E, 94334CE, 94333E/94334E/94335E, 9747E, 1A5639-7, 1A5477, 1A6487, 132B2372, 94330EML/ 9333EML/94335EML, 84330EML/84333EML/84335EML, 8747EML | <b>A</b>        |
| <b>CLEMSA</b>   |                 |
| MUTANCODE, T, T-8, E-CODE N   | <b>A</b>        |
| MASTERCODE MV   | <b>C</b>        |
| <b>DASPI</b>  |                 |
| ZERO RC   | <b>A</b>        |
| <b>DEA SYSTEM</b>   |                 |
| PUNTO 278, GOLDR, GENIE R 273, GENIE R-GT2M, MIO TR, GT2M, TRN  | <b>A</b>        |
| <b>DITEC/ENTREMATI</b>  |                 |
| BIXLP, GOL4, BIXLG, ZEN   | <b>B</b>        |
| <b>DOORHAN</b>  |                 |
| TRANSMITTER 4   | <b>A</b>        |
| <b>DOORMATIC</b>  |                 |
| MILENY, MILENY-EVO  | <b>A</b>        |
| <b>ECOSTAR</b>  |                 |
| RSC, RSE, RSZ   | <b>A</b>        |
| <b>ERREKA</b>   |                 |
| IRIS, ROLLER 2, ROLLER 433, ROLLER 868, SOL433, SOL868, VEGA 433, VEGA 868  | <b>B</b>        |
| <b>FAAC</b>   |                 |
| TML 433SLH, DL 868 SLH, XT 868 SLH, XT 433 SLH, T 868 SLH, T 433 SLH, XT 868 SLH BLACK, XT 433 SLH BLACK  | <b>C</b>        |
| <b>FADINI</b>   |                 |
| JUBI-SMALL, JUBI 433, DIVO 71/4   | <b>B</b>        |
| <b>GENIUS</b>   |                 |
| AMIGO JA332-JA334 868, AMIGOLD 868, KILO 433 JLC, KILO 868 JLC  | <b>C</b>        |

| BRAND<br>MODEL   | TYPE OF<br>COPY |
|--|-----------------|
| <b>GENIUS</b>  |                 |
| BRAVO, ECHO  | <b>B</b>        |
| <b>GIBIDI</b>  |                 |
| AU1600, AU1600 WOOD, AU1680,<br>AU1680 WOOD, DOMINO, MAKO  | <b>B</b>        |
| <b>JCM</b>   |                 |
| NEO, TWIN  | <b>B</b>        |
| <b>JCM</b>   |                 |
| GO, GO PORTIS, GO NORTON, GO MINI  | <b>A</b>        |
| <b>KBLUE</b>   |                 |
| ETH-TEL01  | <b>A</b>        |
| <b>KEY</b>   |                 |
| 900TXB-42R, TXB 44R, SUB 44R   | <b>B</b>        |
| <b>KING GATES</b>  |                 |
| CLIPPER, STYLO   | <b>B</b>        |
| <b>KLING</b>   |                 |
| KUA, KUA E, KUA S  | <b>B</b>        |
| <b>LABEL</b>   |                 |
| SPYCO  | <b>B</b>        |
| <b>LIFE</b>  |                 |
| FIDO   | <b>A</b>        |
| <b>MHOUSE</b>  |                 |
| TX3, TX4, GTX4   | <b>B</b>        |
| <b>MOOVO</b>   |                 |
| MT4G   | <b>B</b>        |
| <b>NICE</b>  |                 |
| SMILO, FLOR-S, VERY-VR, FLOR-S ERA,<br>ONE (ON), ON ERA, INTI, ERGO,<br>PLANO, ONE (ON FM)   | <b>B</b>        |
| <b>NORMSTHAL</b>   |                 |
| RCU 2/4 K, EA 433 2/4 K  | <b>A</b>        |
| <b>NORTON</b>  |                 |
| NEO, TXCD  | <b>B</b>        |
| GO NORTON, GO MINI NORTON  | <b>A</b>        |
| <b>NOVOFERM</b>  |                 |
| MCHS, MICRO-NOVOTRON 502,<br>MINI-NOVOTRON 504,<br>MICRO-NOVOTRON 502,<br>MICRO-NOVOTRON 504,<br>MICRO-NOVOTRON 31,<br>MICRO-NOVOTRON 51, MINI-NOVOTRON 30,<br>MININOVOTRON 50, MNHS,<br>MINI NOVOTRON 522 | <b>A</b>        |
| <b>O&amp;O</b>   |                 |
| TX, T.COM R4-2, T.COM R8-2,<br>TWIN, TX (NEO)  | <b>B</b>        |

| BRAND<br>MODEL   | TYPE OF<br>COPY |
|--|-----------------|
| <b>PRASTEL</b>   |                 |
| MTE, MPSTLE, MPSTP2E, TCE,<br>BFOR, TRQ-P, SLIM-E  | <b>B</b>        |
| <b>PUJOL</b>   |                 |
| TWIN, VARIO, VARIO MARS,<br>VARIO OCEAN, NEO   | <b>A</b>        |
| <b>RIB</b>   |                 |
| LITHIO   | <b>A</b>        |
| <b>ROPER</b>   |                 |
| NEO  | <b>B</b>        |
| GO ROPER, GO MINI ROPER  | <b>A</b>        |
| <b>SABUTOM</b>   |                 |
| BROOVER, BROSTAR   | <b>B</b>        |
| <b>SEAV</b>  |                 |
| BE HAPPY RS, BE SMART  | <b>A</b>        |
| <b>SECULUX</b>   |                 |
| NEO  | <b>B</b>        |
| <b>SILVELOX</b>  |                 |
| Mhz 2007, QUARZ SAW  | <b>A</b>        |
| <b>SIMINOR</b>   |                 |
| CVXNL, MITTO   | <b>B</b>        |
| SIM433   | <b>A</b>        |
| <b>SOMFY</b>   |                 |
| K-EASY, K-EASY NEW,<br>K-EASY OLD, MITTO,<br>KEY GO RTS,<br>TELIS RTS, KEYTIS RTS,<br>KEYTIS RTS NS, ALARMA                                | <b>A</b>        |
| <b>SOMMER</b>  |                 |
| 4010, 4011, 4014 TX03-434-2,<br>4013 TX03-434-4, 4020 TX03-868-4,<br>4026 TX03-868-2, 4022 TX02-434-2,<br>4025 TX02-868-2, 4031 TX08-868-4 | <b>A</b>        |
| <b>STAGNOLI</b>  |                 |
| KALLISTO, VENUS AV223  | <b>A</b>        |
| <b>TAU</b>   |                 |
| 250K-SLIMRP, 250K-SLIMR, 250T-4RP  | <b>B</b>        |
| <b>TELCOMA</b>   |                 |
| FM400E, FM400  | <b>A</b>        |
| <b>TOR LIFT</b>  |                 |
| TORMIT4  | <b>A</b>        |
| <b>V2</b>  |                 |
| TSC, TXC, TRC, HANDY, PHOENIX,<br>PHOX 433, PHOENIX 868, PHOX 868  | <b>B</b>        |
| <b>VDS</b>   |                 |
| ECO-R, TRQ P   | <b>B</b>        |

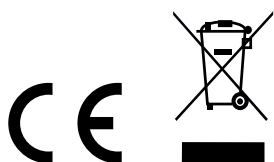

V1.0

**Nexta Tech**

company brand of Team srl  
via G.Oberdan 90, 33074  
Fontanafredda (PN) - Italy  
Ph. +39 0434 998682  
Email: [info@nexta-tech.com](mailto:info@nexta-tech.com)  
Web: [www.nexta-tech.com](http://www.nexta-tech.com)